

Contrast tester  
80x70x30  
Sn = 9 mm

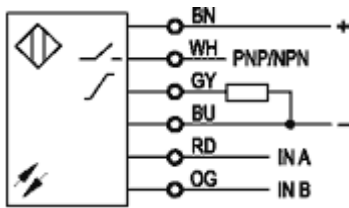
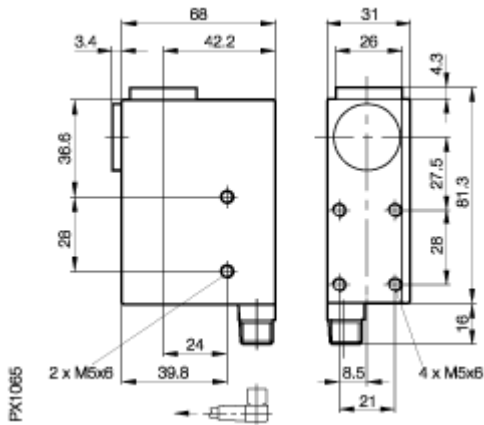

If not differently indicated,  
all values by IEC 947-5-2 (DIN EN60947-5-2)

Specifications subject to change

Balluff GmbH  
Postfach 1160  
73761 Neuhausen  
Telefon (07158) 173-0  
Telefax (07158) 5010

### Common Data

Sensortype	Contrast tester
Switching frequency	10 kHz
Rated operating distance Sn	mm 9
asured operating distance Sa	mm with Teach In adjustable
Indication supply voltage	yes
Indication switching element	yes, red LED
Indication special function	yes, wrong adjustment
Ambient temperature	°C -10...+55°C
On/Off-delay	50µs
Light	Red + Green
Sensitivity adjustment	Teach In
Light spot diameter	Spotsize 1,5x5mm
Permissible ambient light	lux 3000

### Mechanical Data

Measurements BxHxT or DxT	mm 80x70x30
Shock test (EN 60068-2-27)	Halfsinus, 30gn, 11ms
Vibration test (EN 60068-2-6)	10...55Hz, 1,5mm Amplitude 3x2h
Housing material	ZAMA
Material of sensing face	Glass
Degree of protection	IP IP67
Connection	Cable
Weight	600g
Recommended connector	3m

### Electric Data

Current	DC
Switching function	normally-open
Output	PNP/NPN switchable
Rated operational voltage Ue	V 24V
Rated operational current Ie	mA <200mA
Supply voltage	V 10...30V
Ripple	% < 6%
No-load supply current	mA 80mA
Voltage drop	V 1,5V
Short protection	yes
Rated insulation voltage	75V DC
max. load capacity	1µF

21.01.2004 / Online-Information